

1.27mm DUAL ROW SOCKET SMD

(TOP ENTRY TYPE)

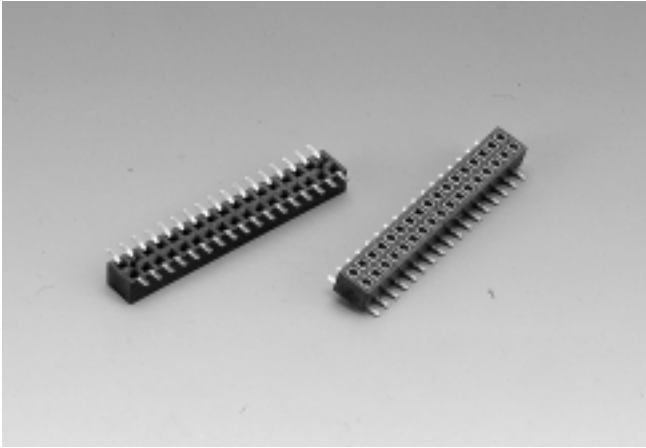

127212FA Series

Mates with 127107, 127108, 127196 Series

Specifications:

- **Insulator material** : Black High Temp . Plastic
- **Max.Processing Temp.** : 230°C for 30 Seconds
- **Terminal Material** : Phosphor Bronze
- **Plating** : Full Gold Plated
- **Max. Current Rating** : 1.0A
- **Voltage Rating** : 150V AC
- **Dielectric Strength** : 500V (Min. 60 seconds)

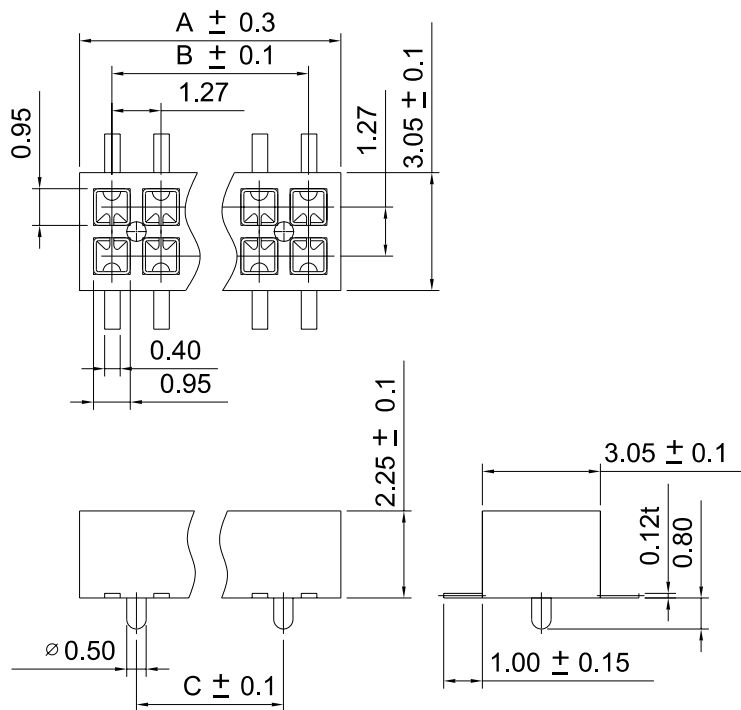

Order Information

127212FA□□□□□00ZU
 1 2 3 4 5

1. 'A' : Straight SMT Type
 2. No. of Pins
 3. Plating
 4. Color 'Z' : Black
 5. Package
- 'U' : Tube Package Without CAP

Reference Page 11

Dimensional Information

SUYIN P/NO.	DIM.A	DIM.B	DIM.C
127212FA006□□00ZU	5.48	3.81	2.54
127212FA010□□00ZU	6.75	5.08	3.81
127212FA012□□00ZU	8.02	6.35	5.08
127212FA020□□00ZU	13.10	11.43	10.16
127212FA022□□00ZU	14.37	12.70	11.43
127212FA024□□00ZU	15.64	13.97	12.70
127212FA026□□00ZU	16.91	15.24	13.97
127212FA030□□00ZU	19.45	17.78	16.51
127212FA034□□00ZU	21.99	20.32	21.59
127212FA040□□00ZU	25.80	24.13	22.86
127212FA050□□00ZU	31.80	30.48	29.21
127212FA060□□00ZU	38.50	36.83	35.56
127212FA080□□00ZU	51.20	49.53	48.26
127212FA100□□00ZU	63.90	62.23	60.96

Recommended P.C.B. Layout

