

**PLEASE CHECK WWW.MOLEX.COM FOR LATEST PART INFORMATION**

**Part Number:** [0334820801](#)  
**Status:** **Active**  
**Overview:** [mx150 sealed connector system](#)  
**Description:** 3.50mm (.138") Pitch MX150™ Sealed Male Connector, Dual Row, 8 Circuits, Polarization A, without Connector Position Assurance, Black

**Documents:**

[3D Model](#) [Product Specification PS-33472-000 \(PDF\)](#)  
[Application Specification \(PDF\)](#) [RoHS Certificate of Compliance \(PDF\)](#)  
[Drawing \(PDF\)](#)

**General**

Product Family	Crimp Housings
Series	<a href="#">33482</a>
Comments	No Connector Position Assurance (CPA)
More Detailed Tech Information	<a href="http://ewcap.uscarteams.org">http://ewcap.uscarteams.org</a>
Overview	<a href="#">mx150 sealed connector system</a>
Product Name	MX150™

**Physical**

Circuits (maximum)	8
Circuits Detail	8
Color - Resin	Black, Natural
Gender	Male
Glow-Wire Compliant	No
Keying to Mating Part	Yes
Lock to Mating Part	Yes
Material - Resin	Modified Polystyrene Alloy
Number of Rows	2
Packaging Type	Bag
Panel Mount	No
Pitch - Mating Interface (in)	0.138 In
Pitch - Mating Interface (mm)	3.50 mm
Polarized to Mating Part	Yes
Stackable	No
Temperature Range - Operating	-40°C to +125°C

**Electrical**

Current - Maximum per Contact	22A
-------------------------------	-----

**Material Info**

**Reference - Drawing Numbers**

Application Specification	AS-33472-100
Packaging Specification	PK-31300-635
Product Specification	PS-33472-000
Sales Drawing	ES-E1AB-14A485-AA, SD-33482-081



**EU RoHS**

**ELV and RoHS Compliant**  
**REACH SVHC Contains SVHC: No**  
**Halogen-Free Status**  
**Not Reviewed**

**China RoHS**



**Need more information on product environmental compliance?**

Email [productcompliance@molex.com](mailto:productcompliance@molex.com)  
 For a multiple part number RoHS Certificate of Compliance, [click here](#)

Please visit the [Contact Us](#) section for any non-product compliance questions.

**Search Parts in this Series**

[33482Series](#)

**Mates With**

[33472](#) Female Dual Row Sealed Connector

**Use With**

[33000](#) MX150™ Tin (Sn) Male Terminal,  
[33011](#) Gold (Au) Male Terminal

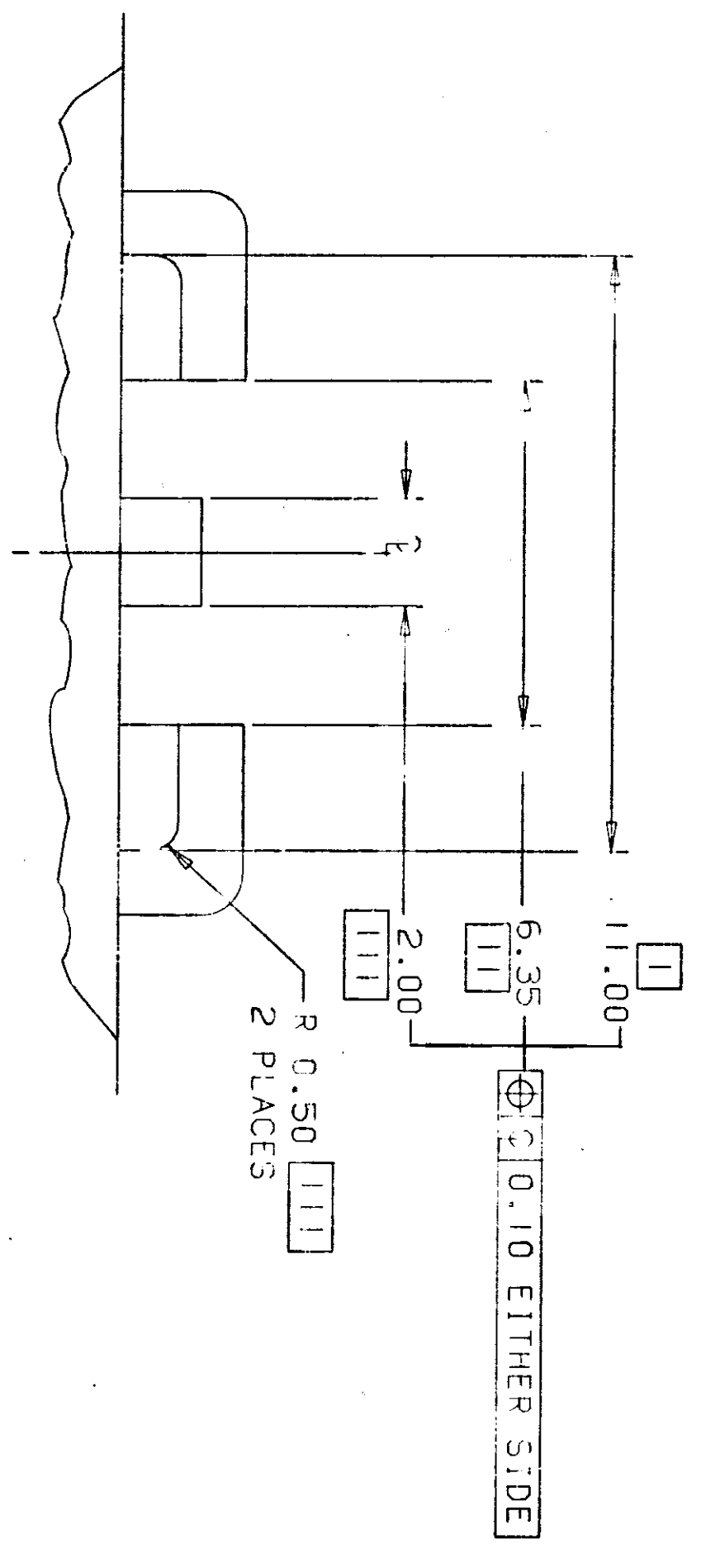
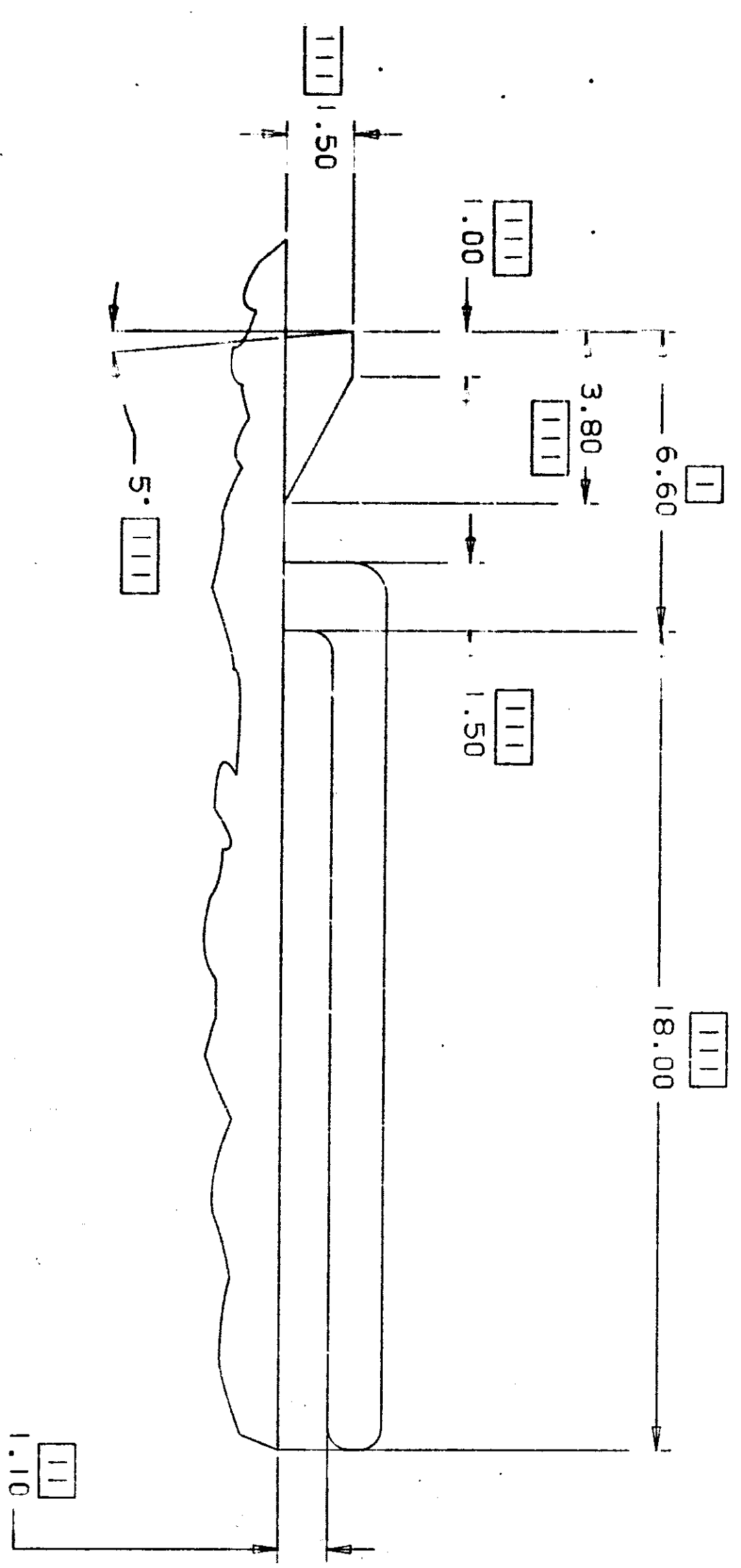
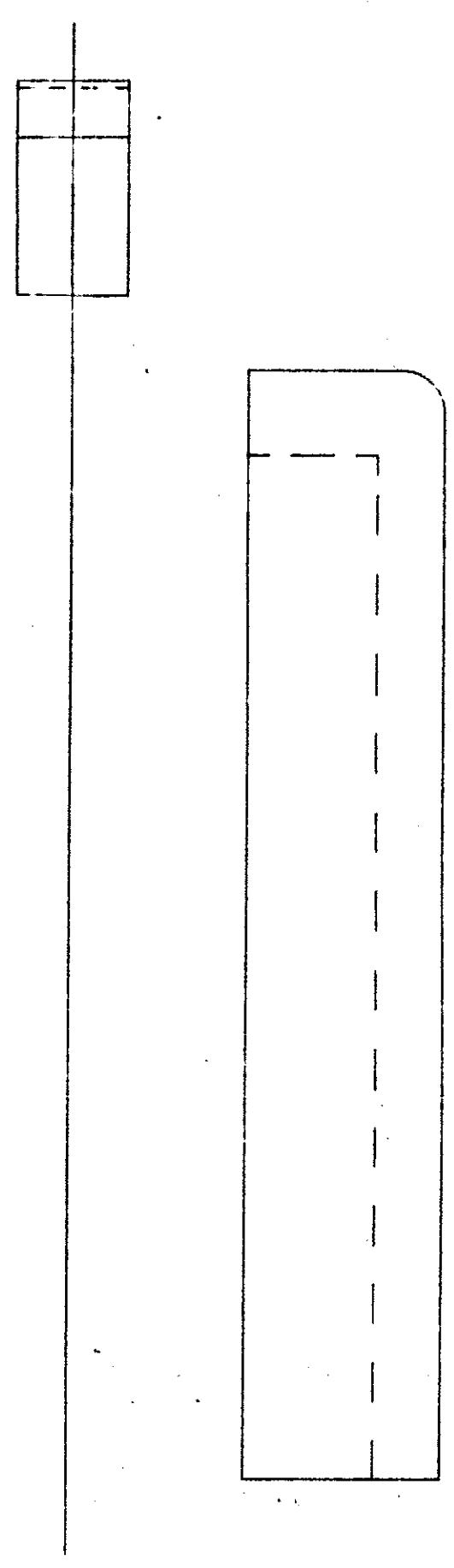

VIEW OF WIRE END OF CONNECTOR

NOTES: UNLESS OTHERWISE SPECIFIED

- GENERAL TOLERANCES:
  - ±0.10 ALL TWO PLACE DIMENSIONS
  - ±0.3 ALL ONE PLACE DIMENSIONS
  - ±1.0° ALL ANGULAR DIMENSIONS
- 0.5° MAXIMUM DRAFT ANGLE
- 0.3 MAXIMUM RADIUS PERMISSIBLE ON ALL EDGES AND FILLETS SHOWN AS SHARP
- ALL RADI: 0.8
- WALL THICKNESS 1.3-1.0

DATE LET	REVISIONS	DR	CK	APP
11-18-77	RELEASED COMPLETE			
	AKI-6000 #86			

NO. ES-EIAB-14A485-AA

**SPIND PRODUCT ENGINEERING**

MILLIMETRES ON ORIGINAL FORMAT - 1:1
10 20 30 40 50 60 70 80 90 100 110 120 130 140
DO NOT SCALE ABOVE SCALE FOR REFERENCE ONLY
REF
DRAWN BY: <i>Janice</i>
DATE: <i>11-8-77</i>
CHECKED: <i>CE</i>
SCALE: <i>1/2"</i>
APPROVED: <i>MA</i>
COCG

UNLESS OTHERWISE SPECIFIED  
 DIMENSIONS ARE IN MILLIMETRES  
 MACHINED DIM. 1  
 ANGULAR DIM. 1

NAME: SPECIFICATION - RETAINER - WIRE  
 CONNECTOR SLEEVE  
 MATERIAL: *55*  
 DATE: *11-8-77*  
 NO. ES-EIAB-14A485-AA

ASSEMBLY PART NUMBER	COLOR	KEYING OPTION	DIMENSIONS		CAVITY TYPE & STATUS (X = PLUGGED)															
			A	B	1	2	3	4	5	6	7	8								
33482-0801	BLACK	A	60	60																
33482-0802	LT.GRAY	B	25	60																
33482-0803	BROWN	C	60	25																
33482-0804	GREEN	D	25	25																
33482-0805	CUSTOM	TBD																		
33482-0806	BLACK	A	60	60									X							
33482-0807	LT.GRAY	B	25	60								X								
33482-0808	BROWN	C	60	25								X								
33482-0809	GREEN	D	25	25								X								
33482-0810	CUSTOM	TBD										X								
33482-0811	BLACK	A	60	60								X	X							
33482-0812	LT.GRAY	B	25	60								X	X							
33482-0813	BROWN	C	60	25								X	X							
33482-0814	GREEN	D	25	25								X	X							
33482-0815	CUSTOM	TBD										X	X							
33482-0816	BLACK	A	60	60	X							X	X							
33482-0817	LT.GRAY	B	25	60	X							X	X							
33482-0818	BROWN	C	60	25	X							X	X							
33482-0819	GREEN	D	25	25	X							X	X							
33482-0820	CUSTOM	TBD										X	X							
33482-0821	BLACK	A	60	60	X							X	X							X
33482-0822	LT.GRAY	B	25	60	X							X	X							X
33482-0823	BROWN	C	60	25	X							X	X							X
33482-0824	GREEN	D	25	25	X							X	X							X
33482-0825	CUSTOM	TBD										X	X							X
33482-0826	BLACK	A	60	60	X	X	X					X	X	X						X
33482-0827	BLACK	A	60	60								X	X							X
33482-0828	BLACK	A	60	60				X				X	X							X
33482-0829	BLACK	A	60	60			X	X	X	X	X	X	X							X
33482-0830	BLACK	A	60	60								X	X							X
33482-0831	BLACK	A	60	60				X				X	X							X
33482-0832	BLACK	A	60	60								X	X							X
33482-0833	BLACK	A	60	60	X			X	X	X	X	X	X	X						X
33482-0834	BLACK	A	60	60	X	X	X	X	X	X	X	X	X	X						X
33482-0835	BLACK	A	60	60								X	X							X
33482-0836	BLACK	A	60	60			X	X				X	X							X
33482-0837	BLACK	A	60	60	X							X	X							X
33482-0838	BLACK	A	60	60			X	X				X	X	X						X

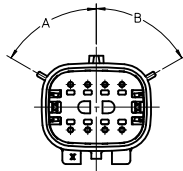

KEYING OPTION  
SEE TABLE SCALE 2:1

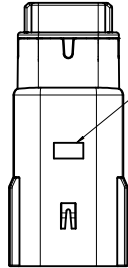

OPTIONAL TRACEABILITY  
INFORMATION LOCATED IN  
THIS AREA

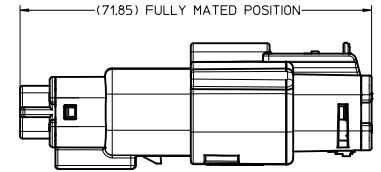

SCALE 1:1

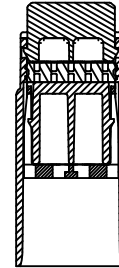

SECTION A-A

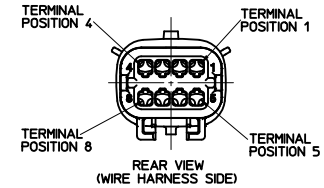

REAR VIEW  
(WIRE HARNESS SIDE)

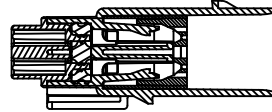

SECTION B-B  
(BLADE SHOWN IN FULL-LOCK POSITION)  
SEE NOTE 2

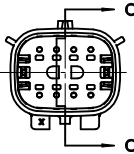
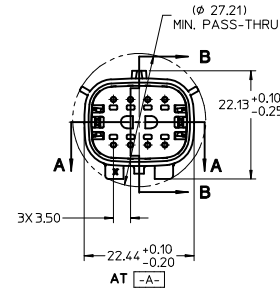

SECTION C-C  
(BLADE SHOWN IN PRE-LOCK POSITION)  
SEE NOTE 2

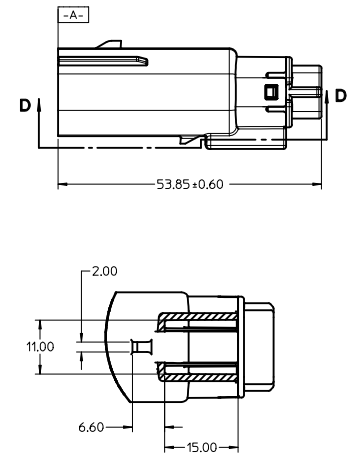

SECTION D-D

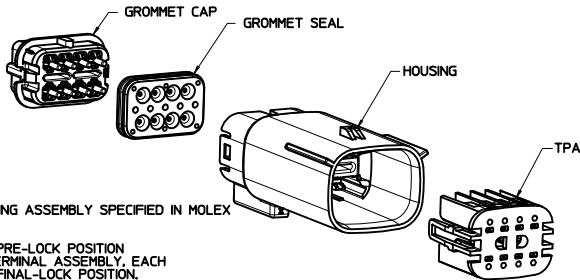

NOTES: UNLESS OTHERWISE SPECIFIED

- DESIGNED TO MATE WITH RECEPTACLE HOUSING ASSEMBLY SPECIFIED IN MOLEX CHARTED DRAWING SD-33472-081.
- ASSEMBLY SHIPPED WITH BLADE INSERT IN PRE-LOCK POSITION (SEE SECTION C-C PRE-LOCK). UPON FULL TERMINAL ASSEMBLY, EACH BLADE INSERT MUST BE SNAPPED INTO ITS FINAL-LOCK POSITION.
- FOR BLADE TERMINALS TO BE USED WITH THIS ASSEMBLY, SEE DRAWING SD-33000-001.
- SYSTEM TO BE USED WITH WIRE WITHIN DIAMETER RANGE OF 1.5mm TO 2.5mm.
- MATERIAL: SPS/NYLON BLEND, 20% GLASS FILLED.
- CHENGDU ASSEMBLIES SHALL CONFORM TO PACKAGING SPECIFICATION PK-31300-635
- SHALL CONFORM TO PRODUCT SPECIFICATION PS-33472-000.
- ASSEMBLY CONFORMS TO SAE/USCAR-2 REV 4 WITH THE FOLLOWING EXCEPTIONS:  
TERMINAL INSERTION FORCE FOR WIRE SIZE ABOVE 2.5mm NOT EXCEEDING 2.69mm SHALL NOT EXCEED 45 NEWTONS.

ENTER DESCRIPTION IEC NO: UAU2010-1454 DRAWN BY: DRWN:AH01 CHECKED BY: CHKD:GRFFTHS APPROVED BY: APPR:VKOSHY DATE: 2010/02/04 DATE: 2010/02/17 DATE: 2010/02/17	QUALITY SYMBOLS ∇=0 ∇=0 ∇=0	GENERAL TOLERANCES (UNLESS SPECIFIED) <table border="1"> <tr><th></th><th>mm</th><th>INCH</th></tr> <tr><td>4 PLACES</td><td>±---</td><td>±---</td></tr> <tr><td>3 PLACES</td><td>±---</td><td>±---</td></tr> <tr><td>2 PLACES</td><td>±0.10</td><td>±---</td></tr> <tr><td>1 PLACE</td><td>±0.3</td><td>±---</td></tr> </table>			mm	INCH	4 PLACES	±---	±---	3 PLACES	±---	±---	2 PLACES	±0.10	±---	1 PLACE	±0.3	±---	DIMENSION STYLE <b>MM ONLY</b>	SCALE <b>2:1</b>	DESIGN UNITS <b>METRIC</b>	THIRD ANGLE PROJECTION
			mm	INCH																		
4 PLACES	±---	±---																				
3 PLACES	±---	±---																				
2 PLACES	±0.10	±---																				
1 PLACE	±0.3	±---																				
DRAFT WHERE APPLICABLE MUST REMAIN WITHIN DIMENSIONS		MATERIAL NO. <b>AS NOTED</b>		DOCUMENT NO. <b>SD-33482-081</b>		SHEET NO. <b>1 OF 1</b>																

TITLE  
**MX150 BLADE CONNECTOR ASSEMBLY 2 ROW SEALED, 8 WAY**

DATE: 06-17-02  
DATE: 06-17-02  
DATE: 06-17-02

MOLEX INCORPORATED

THIS DRAWING CONTAINS INFORMATION THAT IS PROPRIETARY TO MOLEX INCORPORATED AND SHOULD NOT BE USED WITHOUT WRITTEN PERMISSION