

LOW VOLTAGE RECTIFIER Transformer
with horizontal channel frames.

- Primary voltage, 115 Volts, 60 Hz.
- Primary and secondary leads 8-10" long.
- 2-hole horizontal mounting.
- 5 sizes are available, covering the range: 10 to 50 VA.
- CSA listed (LR 47366).

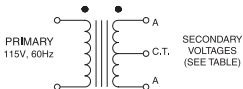

MECHANICAL

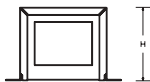
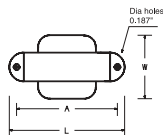

SECONDARY VOLTAGES
(SEE TABLE)

Dimensions, Inches

P/N	DIMENSIONS			PIN SPACING A
	L	W	H	
4766	3.25	2.00	2.00	2.81
4767	3.25	2.25	2.00	2.81
4768	3.69	2.13	2.31	3.13
4769	4.00	2.25	2.63	3.56
4770	4.00	2.50	2.63	3.56

ELECTRICAL SPECIFICATION

Part No.	Secondary Voltages (A-A)		
	F.L. Volts	N.L. Volts	Current Amps
4766-01	6.3	7.25	1.20
4766-02	6.3	7.14	2.00
4766-03	10.0	11.00	1.00
4766-04	14.0	16.00	1.00
4766-05	20.0	22.00	0.50
4766-06	28.0	32.00	0.50
4766-07	30.0	34.20	0.50
4766-08	36.0	39.40	0.30
4766-09	44.0	50.60	0.25
4766-10	50.0	57.00	0.30
4767-01	8.5	9.60	2.00
4767-02	36.0	40.00	0.50
4767-03	16.0	17.60	1.00
4768-01	6.3	6.90	4.00
4768-02	8.5	9.50	3.00
4768-03	10.0	10.80	2.00
4768-04	12.6	13.80	2.00
4768-05	20.0	22.00	1.00
4768-06	25.0	27.50	1.00
4768-07	28.0	30.80	1.00
4768-08	44.0	48.10	0.50
4768-09	50.0	55.00	0.50

Part No.	Secondary Voltages (A-A)		
	F.L. Volts	N.L. Volts	Current Amps
4769-01	14.0	15.30	2.00
4769-02	18.0	19.60	1.50
4770-01	8.5	9.04	4.00
4770-02	10.0	10.50	3.00
4770-03	16.0	17.00	2.20
4770-04	16.0	17.40	3.00
4770-05	20.0	21.40	2.00
4770-06	25.0	26.80	1.50
4770-07	33.0	35.00	1.00
4770-08	36.0	39.50	1.00
4770-09	44.0	47.40	1.00
4770-10	50.0	54.50	1.00
4770-11	60.0	65.20	0.50
4770-12	80.0	85.50	0.50
4770-13	100.0	107.00	0.50
4770-14	120.0	129.50	0.30